

INSTRUCTIONS



Separatory Funnel Rack

Catalog No. 18964-0000

ASSEMBLY:

1. Place the base on a table or benchtop.
2. Screw plugs into holes not being used.
3. Thread thumbscrews into collar then insert collar into the underside of the round shelf. **Note:** *The underside is the one without the numerals.*
4. Thread the riser into the base and tighten.
5. Holding the round shelf in one hand, lower it down over the riser, so that it passes through the collar.
6. Adjust shelf to the desired height, and tighten thumbscrew on collar until finger tight.
7. The Separatory Funnel Rack is now ready for use.

INSTRUCTIONS FOR USE:

1. Place three inserts into slots around each of the six funnel openings in the shelf.
2. For small or medium sized funnels, ensure that each insert is oriented with the *long* end of the insert pointing into the shelf opening.
3. Place the funnel into the shelf opening, making sure that the funnel sits firmly on all three inserts.
4. Repeat steps 2 and 3 for each additional funnel.
5. The rack is now ready for use with the funnels.
6. For large funnels, follow the above steps, but ensure that the inserts are oriented with the *short* end pointing into the shelf opening.
7. The rack must be used only with the inserts provided; three inserts must be used at all times to support every funnel during use.

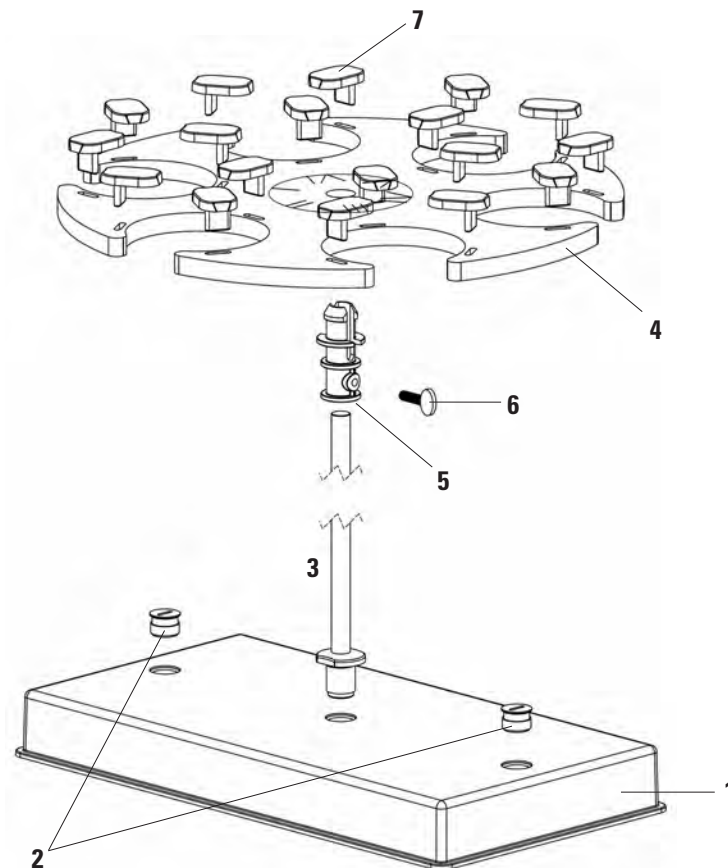

BEL-ART PRODUCTS

661 Route 23 South, Wayne, NJ 07470-6814 USA
 TEL: 1-800-4BEL-ART • FAX: 973-694-7199 • www.belart.com

918303027

9/08

Scienceware® is a registered TM of Bel-Art Products • Bel-Art Products assumes no obligation or liability for any advice furnished by it, or for results obtained with respect to these products. All such advice is given and accepted at the buyer's risk.

© 2008 Bel-Art Products. All Rights Reserved.

	DESCRIPTION	PART NUMBER	QTY
1	Base	919303010	1
2	Plugs	918303008	2
3	Support Rod	918303012	1
4	Shelf	918303006	1
5	Collar	918303013	1
6	Thumb Screw	999321497	1
7	Inserts	918303007	18